

PLANTA BAIXA - JARDINEIRAS
ESCALA 1/50

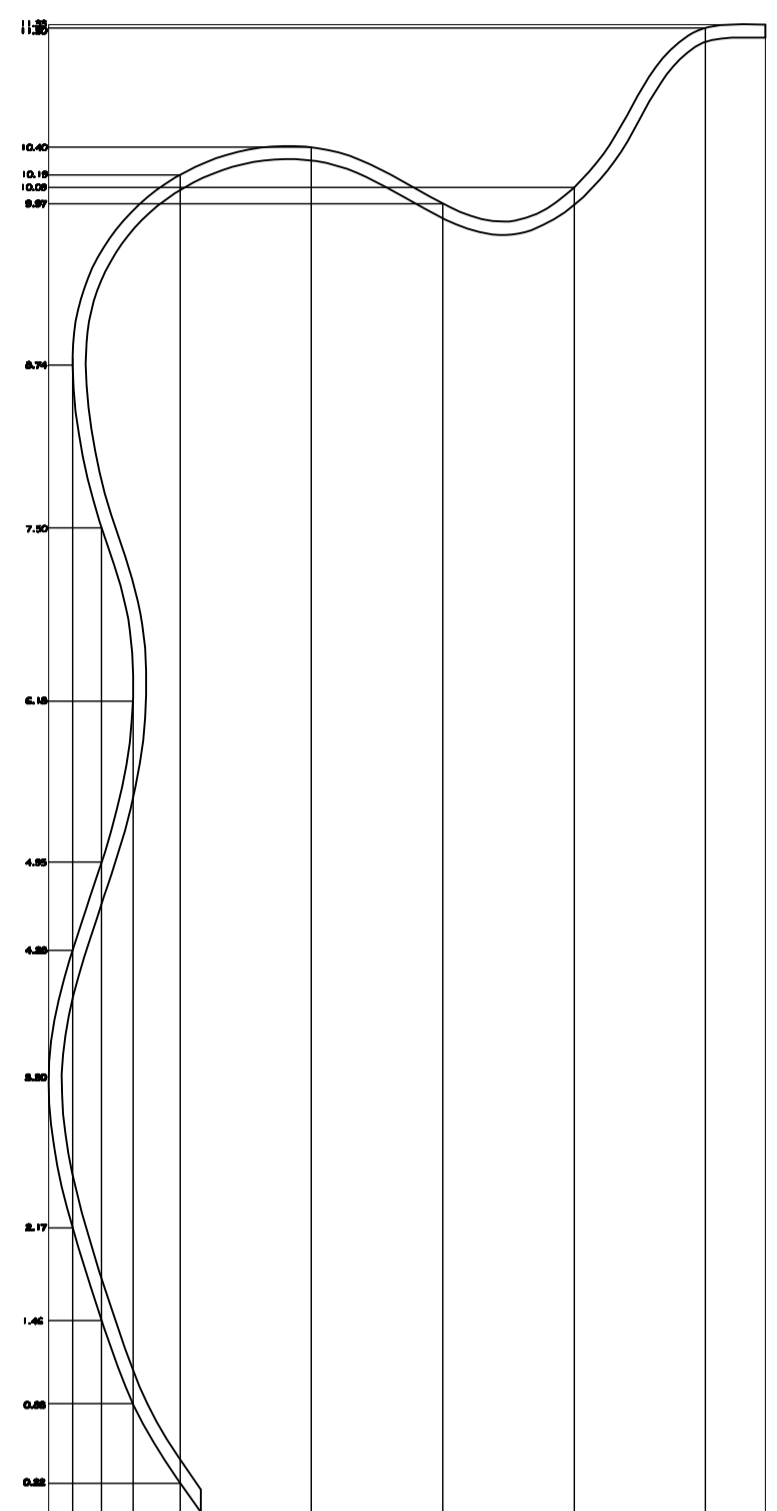

altura da jardineira: 2.10m
DETALHAMENTO - JARDINEIRA 01
ESCALA 1/50

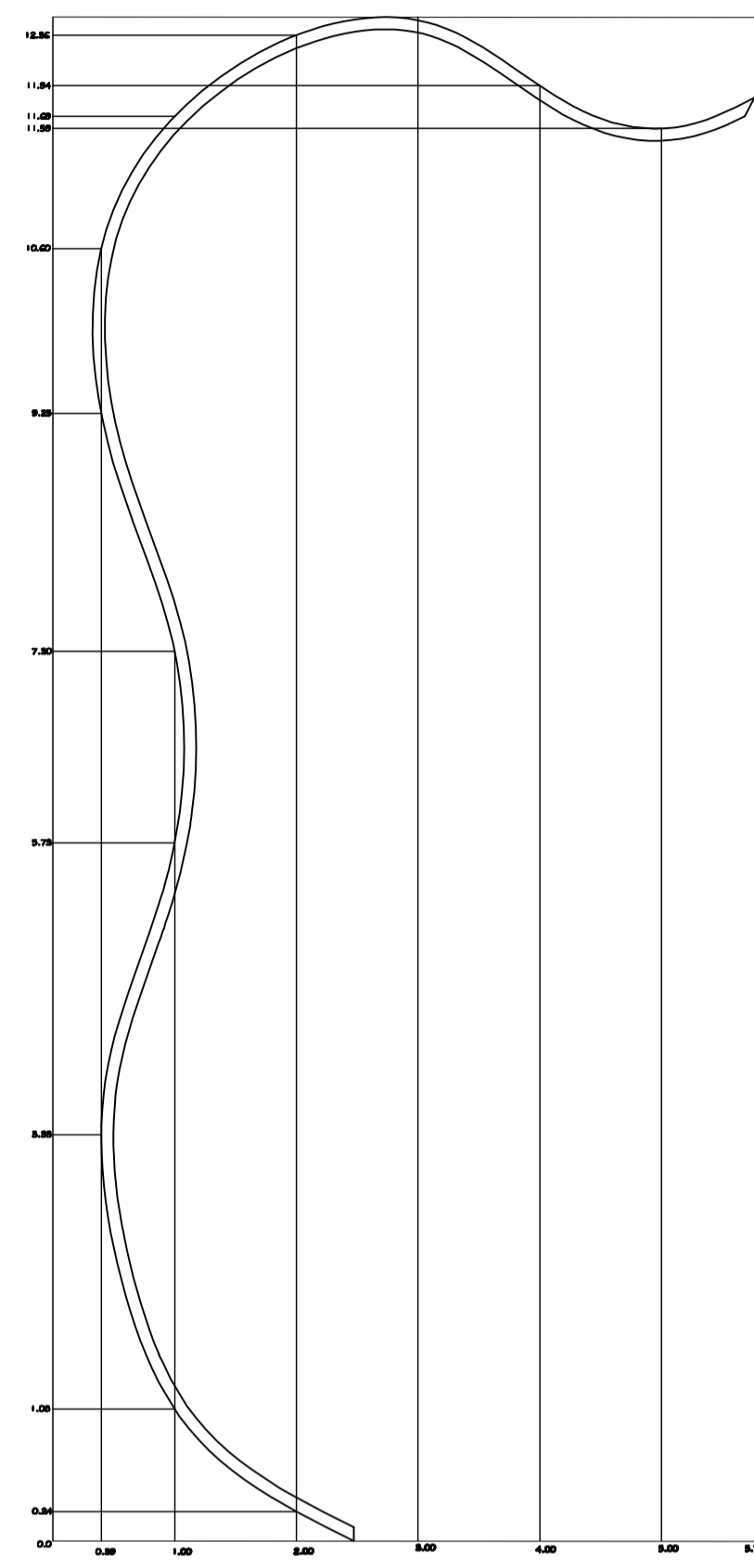

altura da jardineira: 1.40m
DETALHAMENTO - JARDINEIRA 02
ESCALA 1/50

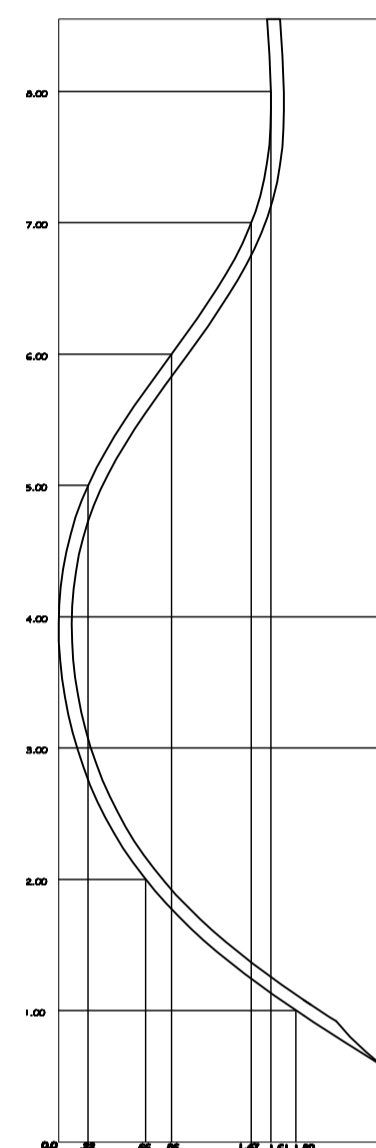

altura da jardineira: 0.70m
DETALHAMENTO - JARDINEIRA 03
ESCALA 1/50

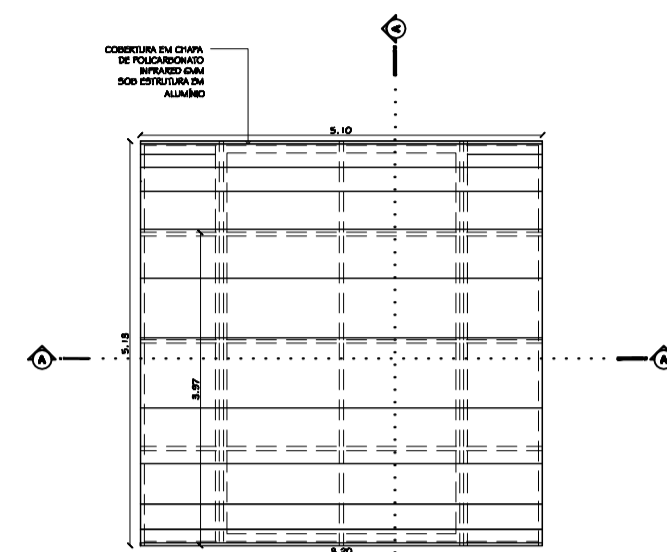

PLANTA BAIXA - CLARABÓIA
ESCALA 1/50

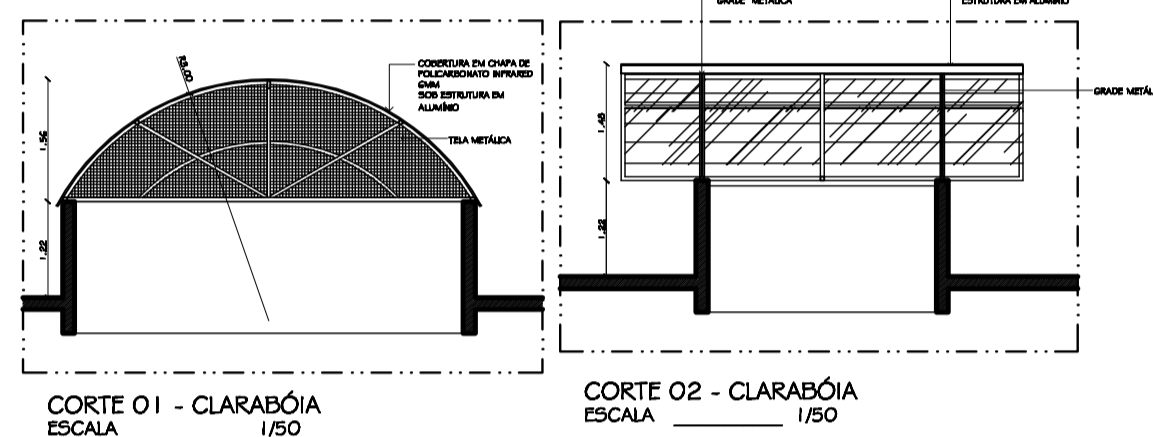

CORTE 01 - CLARABÓIA
ESCALA 1/50

CORTE 02 - CLARABÓIA
ESCALA 1/50

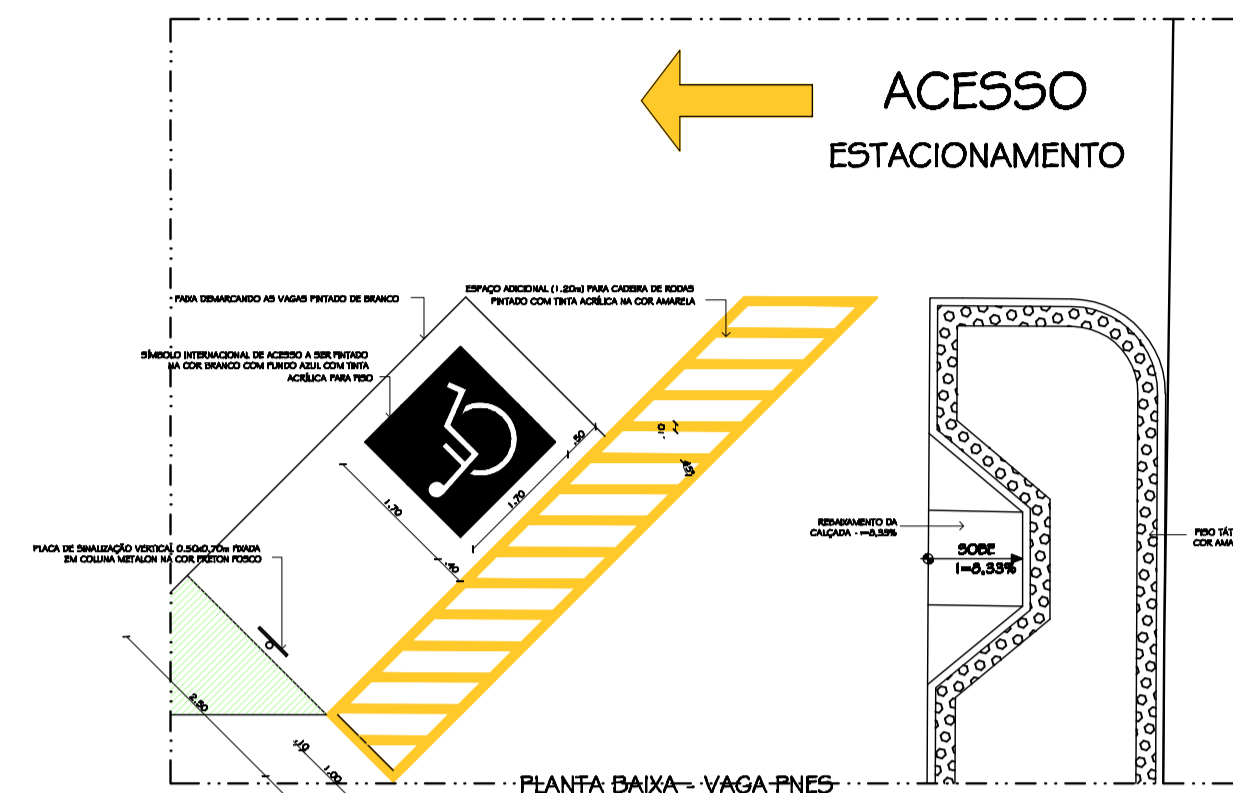

PLANTA BAIXA - VAGA PNE
ESCALA 1/50

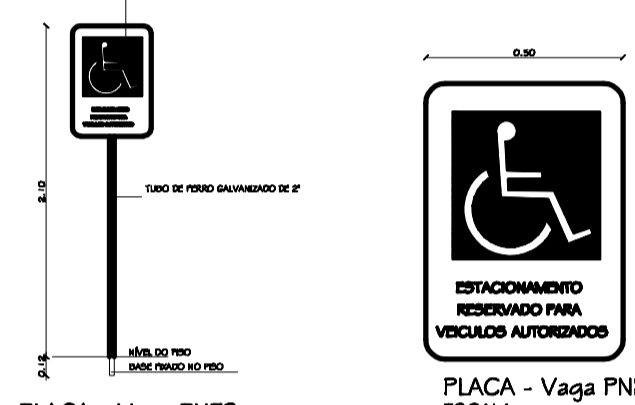

PLACA - Vaga PNE
ESCALA 1/25

PLACA - Vaga PNE
ESCALA 1/10

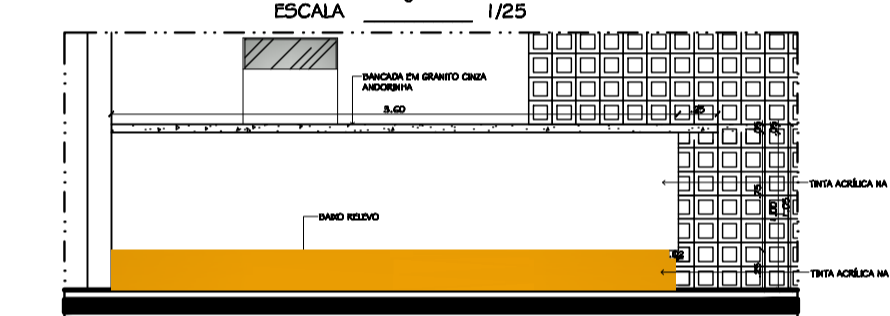

VISTA 01 - Bancada do Café
ESCALA 1/25

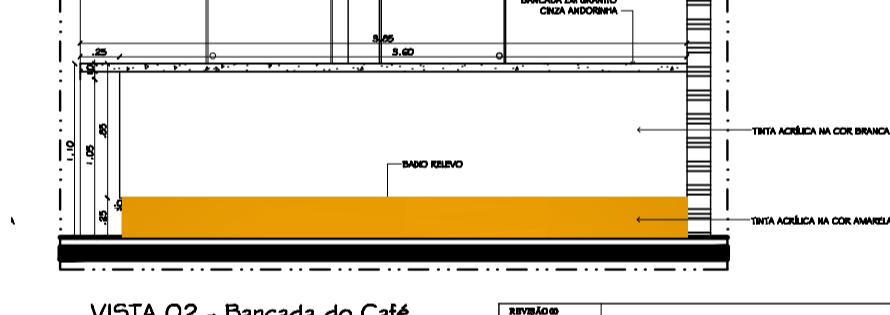

VISTA 02 - Bancada do Café
ESCALA 1/25

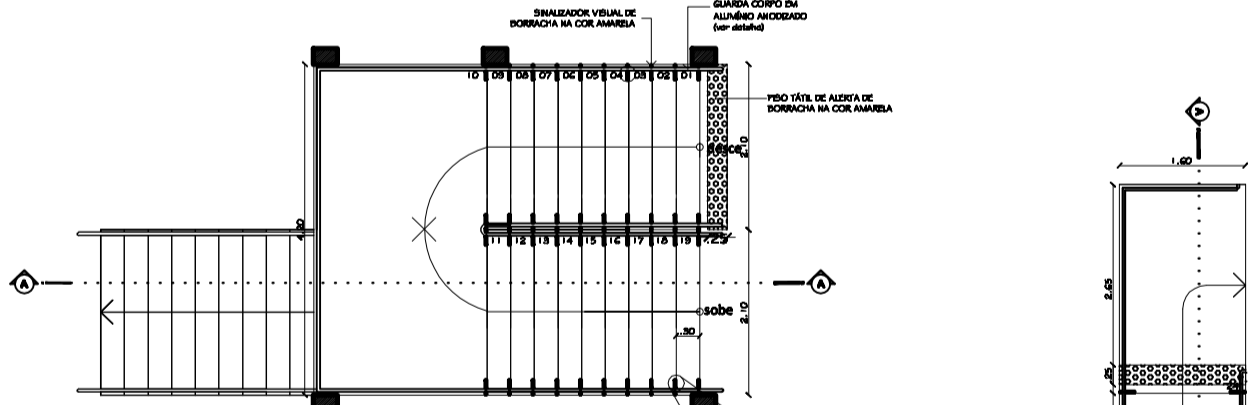

PLANTA BAIXA - ESCADA VIVÊNCIA
ESCALA 1/50

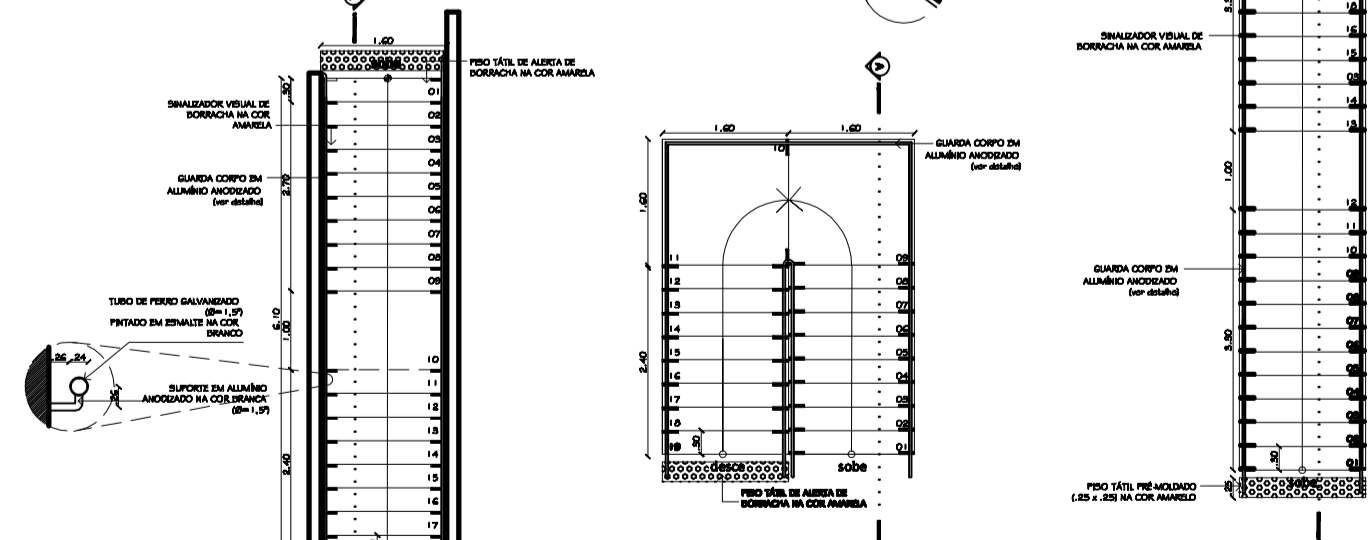

PLANTA BAIXA - ESCADA TEATRO
ESCALA 1/50

PLANTA BAIXA - ESCADA TEATRO
ESCALA 1/50

PLANTA BAIXA - ESCADA EXTERNA
ESCALA 1/50

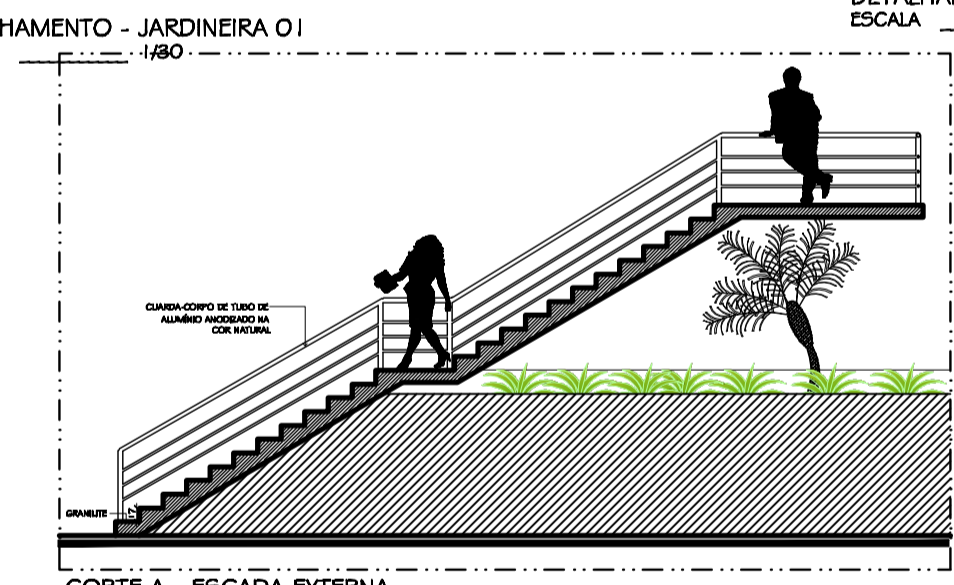

CORTE A - ESCADA EXTERNA
ESCALA 1/50

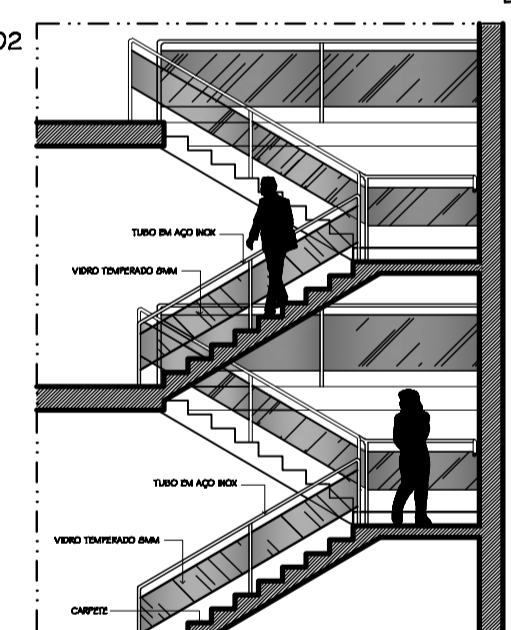

CORTE A - ESCADA TEATRO
ESCALA 1/50

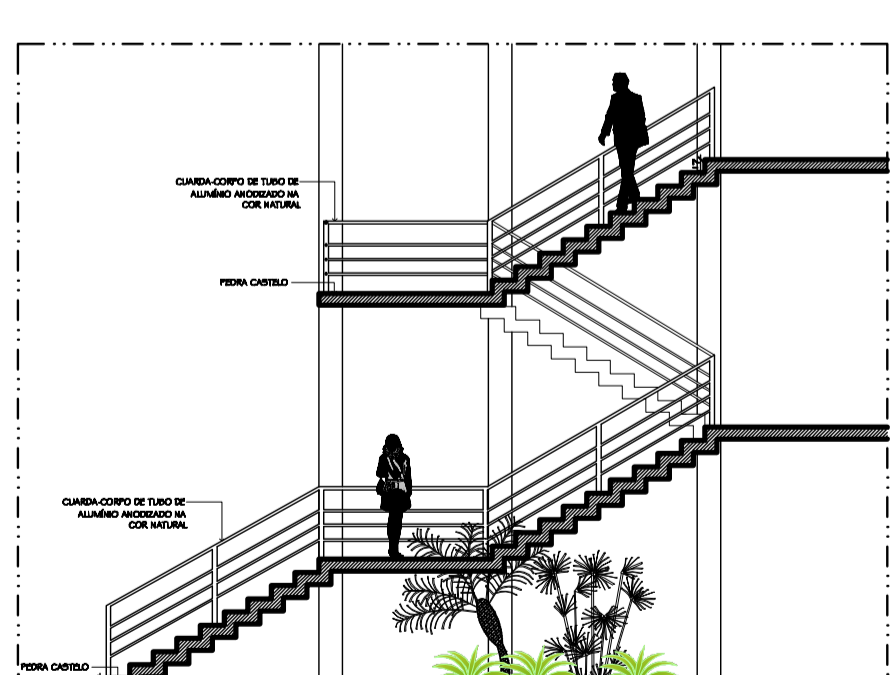

CORTE A - ESCADA VIVÊNCIA
ESCALA 1/50

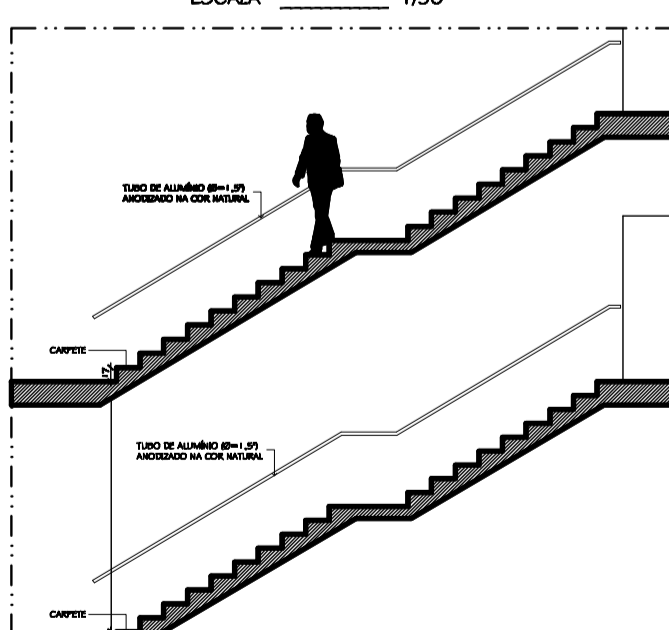

CORTE A - ESCADA TEATRO
ESCALA 1/50

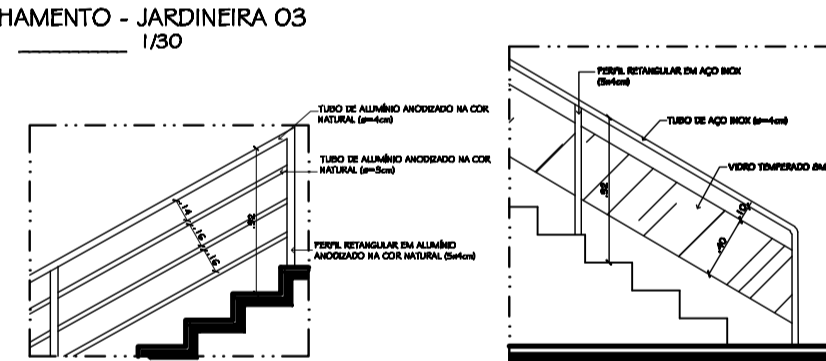

DETALHE - Guarda-corpo das Escadas
ESCALA 1/25

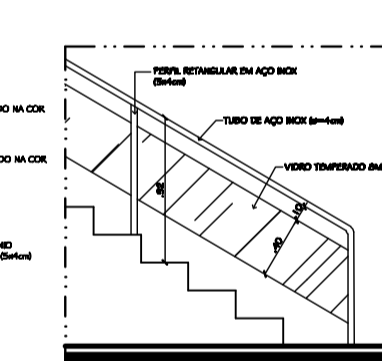

DETALHE - Guarda-corpo da Escada do Teatro
ESCALA 1/25

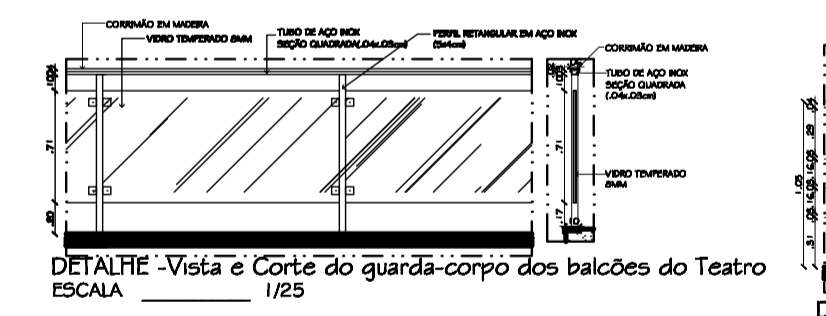

DETALHE - Vista e Corte do guarda-corpo dos balcões do Teatro
ESCALA 1/25

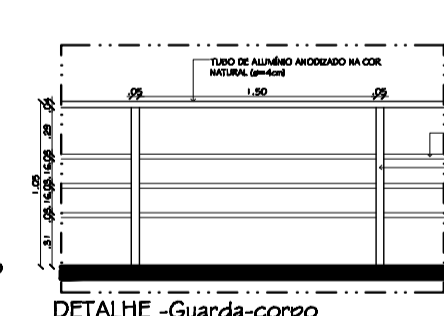

DETALHE - Guarda-corpo
ESCALA 1/25

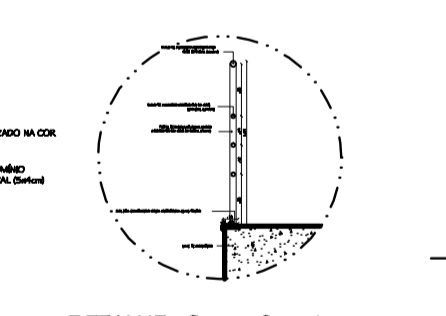

DETALHE - Corte Guarda-corpo
ESCALA 1/25

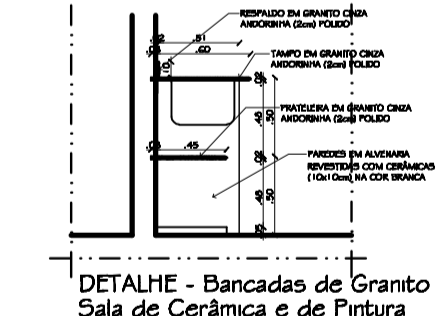

DETALHE - Bancadas de Granito Sala de Cerâmica e de Pintura
ESCALA 1/25

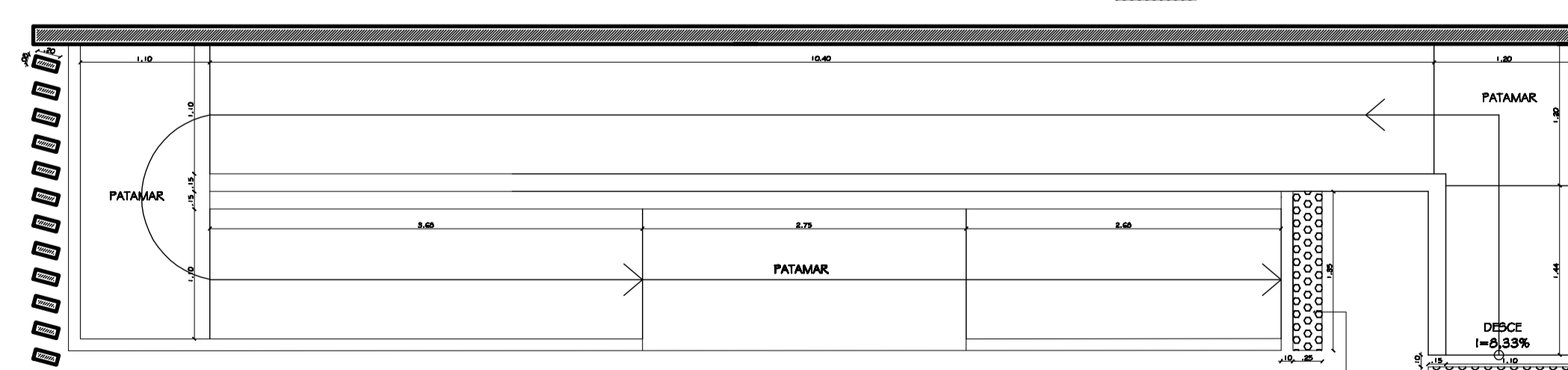

PLANTA BAIXA - Rampa de acesso ao Anfiteatro
ESCALA 1/25

PROJETO	MISSÃO SOCIAL
02/01/2009	
03/01/2009	SOLICITAÇÃO CONVENIÊNTE PARCEIRO TÉCNICO Nº 406/09-021
PROJETO	PROJETO
MANUELE ANDRADE COSTA	MANUELE ANDRADE COSTA
Arq'eng ARQ	
MANUELE ANDRADE COSTA	
PROJETO EXECUTIVO ARQUITETÔNICO DA CONSTRUÇÃO DO PRÉDIO ANEXO AO DEAR2	
UNIVERSIDADE FEDERAL DO RIO DE JANEIRO - UFRJ	
CAMPUS UNIVERSITÁRIO	
DETALHAMENTO	
INDICADA	05/06/2009 01
ARQUITETO	ARQ. DETALHES, ANEXO 2012.dwg